

M040

DIY handmade  
goods--  
The Sound of the Sea



M040 Instruction manual

# NOTICE OF ASSEMBLE

## Making tips

1. LED wiring indication: White=Positive; Grey=Negative.
2. Use a craft blade to carefully skim over the plastic to bare the copper wire.
3. For LED wiring extension, please refer to the below steps:

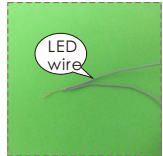

Twist the copper of both LED wire and extension wire together.



Do the same on the white wire. Remarks: Tie a knot at the end of the grey wire to differentiate the polarity.

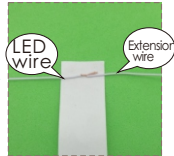

Place the duly twist wire on the tapes provided.



Roll and wrap the wire.

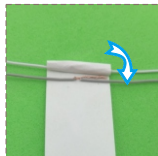

Place another wire next to it. Remarks: DO NOT contact both copper wire to avoid short circuit.



Roll and wrap it together.

## Warnings

- The product is not suitable for children under 14 years old. The should be under custody of adults when playing with the product.
- There are small parts, please do not swallow them for avoiding dangerous accidents.

## Tips for assembling

1. Pictures shown on the package may be slightly different from the actual product.
2. Please use the provided tracing paper for cutting purpose to achieve the best outcome.
3. Product designs and specification may be subject to change without advance notice for purpose of making improvement.
4. Testing on LED function:

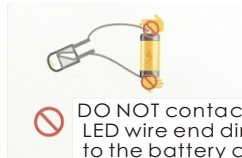

DO NOT contact the LED wire end direct to the battery cell.

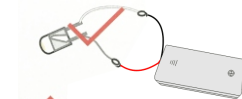

Use the provide battery holder. Make sue the correct polarity.

## How to assemble the battery holder



1. Material and tools needed: Battery holder, LED bulb, tape, screw driver and 2 piece AAA size battery(not provided)



2. Use screw driver and take the lid off from the battery holder.

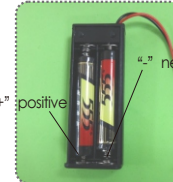

3. Insert the battery take notes on the polarity.

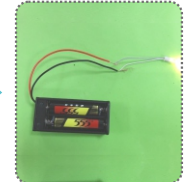

4. Connect the red wire to grey wire. Connect the black wire to white wire.



5. Wrap the exposed wire with the tapes.

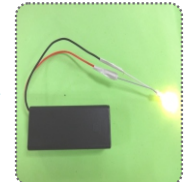

6. Place the box lid and fastness with screw driver.

# Product information



TV console

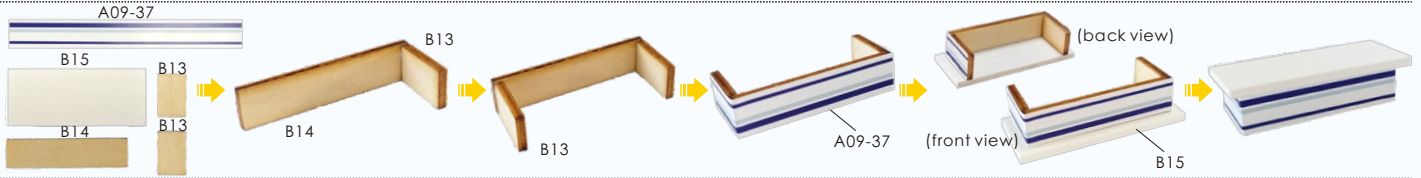

TV



Photo

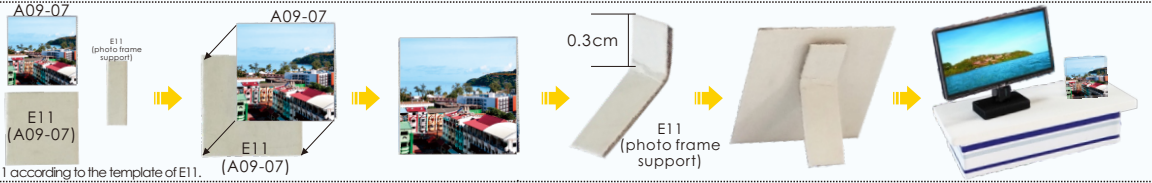

Table

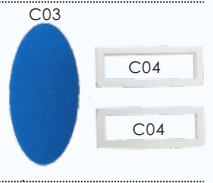

Fruit disc

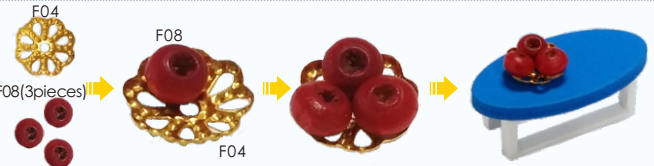

Cup

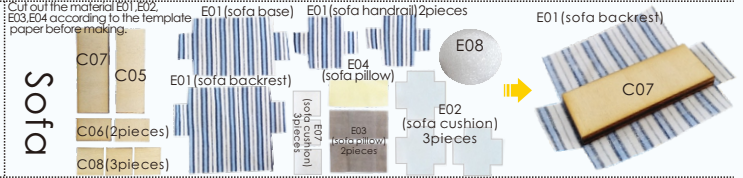



Piano

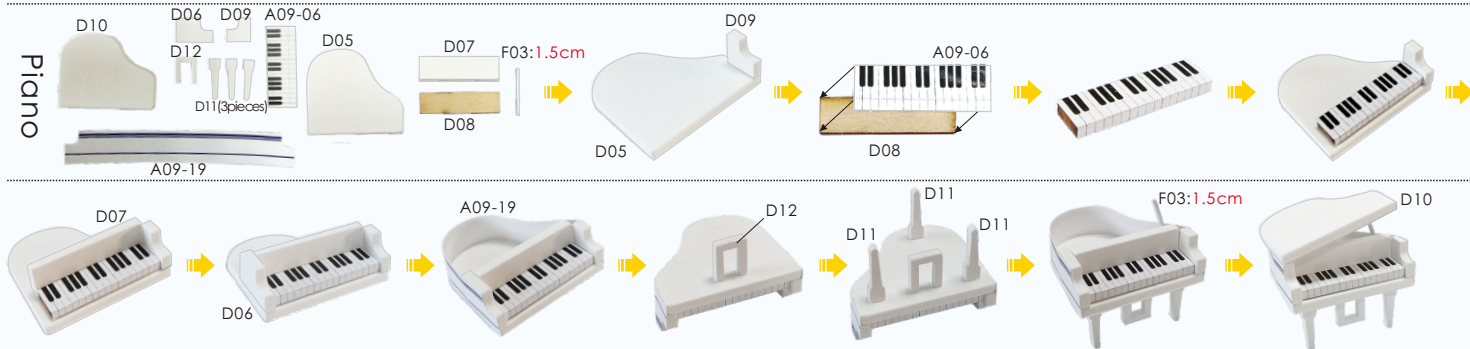

Piano stool

Cut out the material E01, E07, according to the template paper before making.

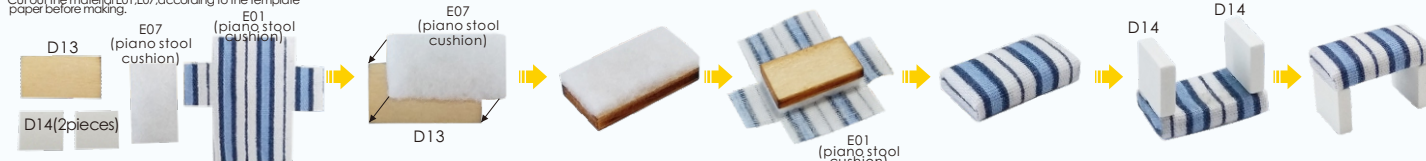

Beach chair

Cut out the material E05 according to the template paper before making.



BOOK



Life ring

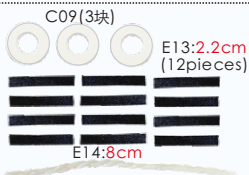

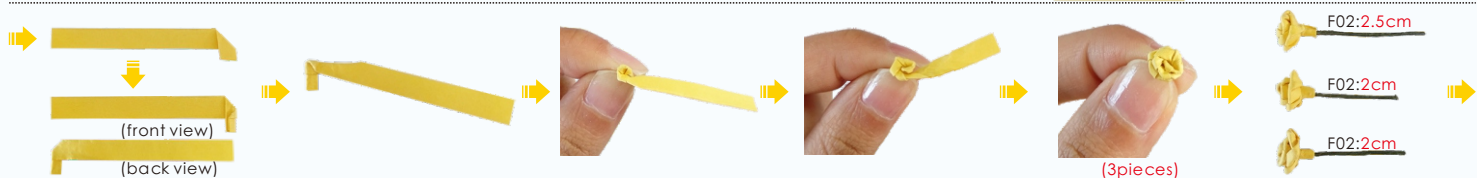

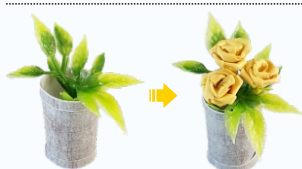

Potted plant

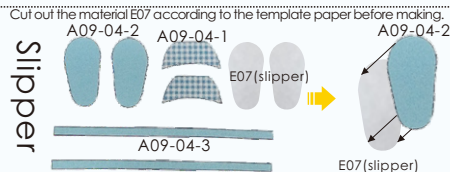
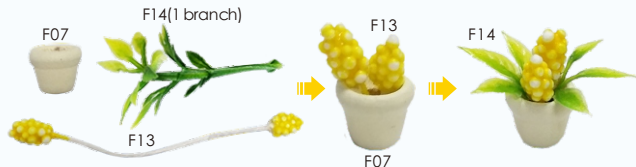

Slipper



Cut out the material E12 according to the template paper before making.

Floor lamp

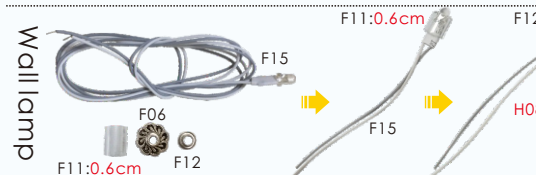
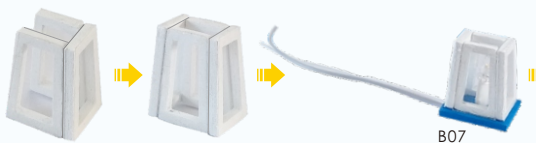
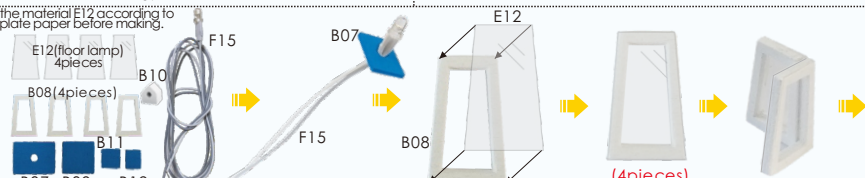

Wall lamp

Bedside lamp

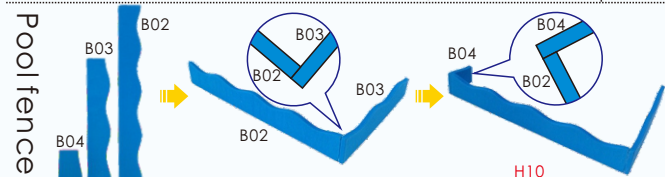
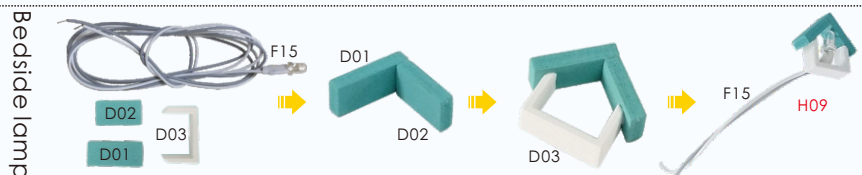

Pool fence

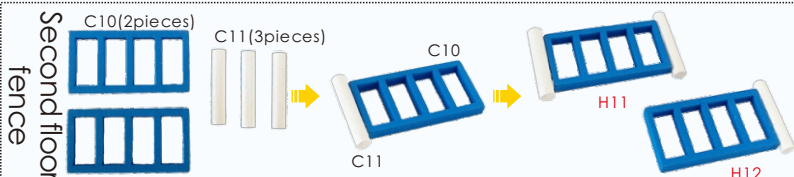

Second floor fence

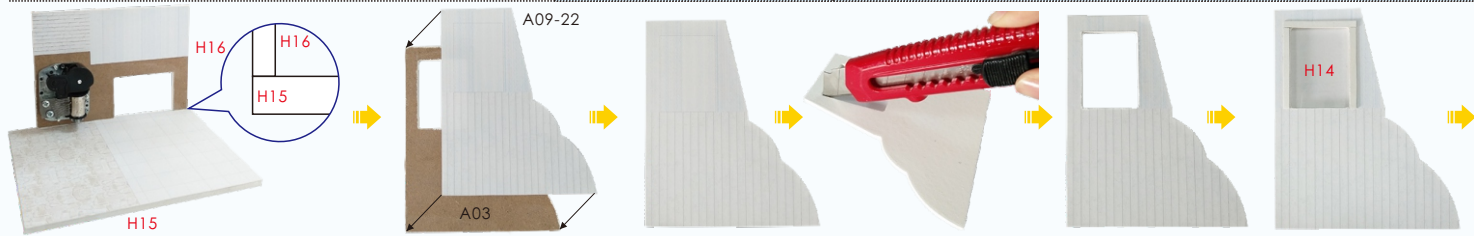
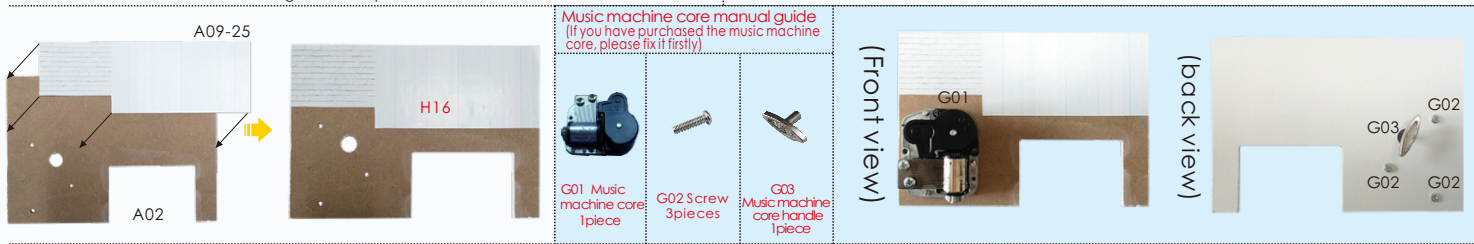
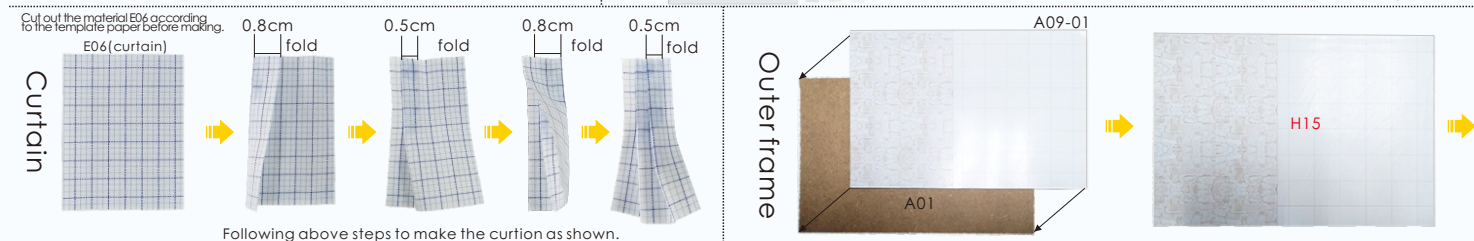
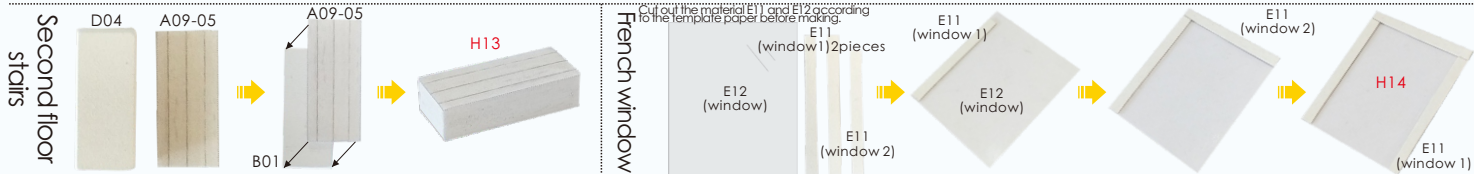

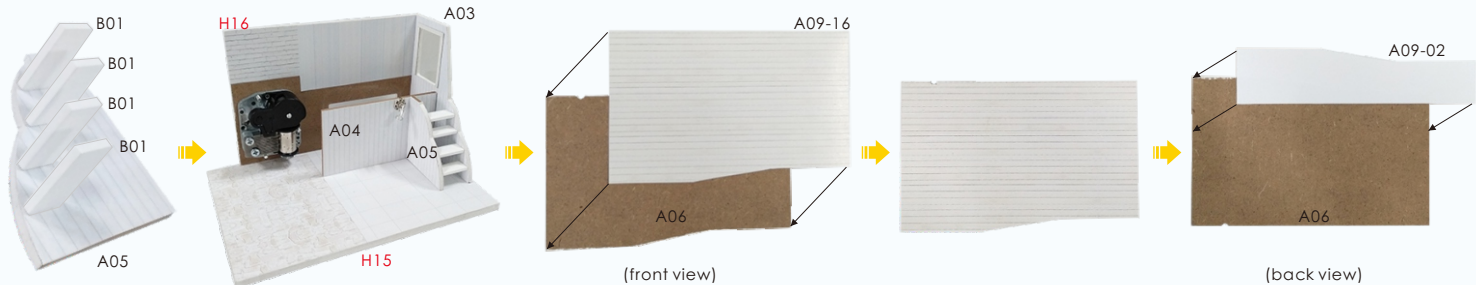
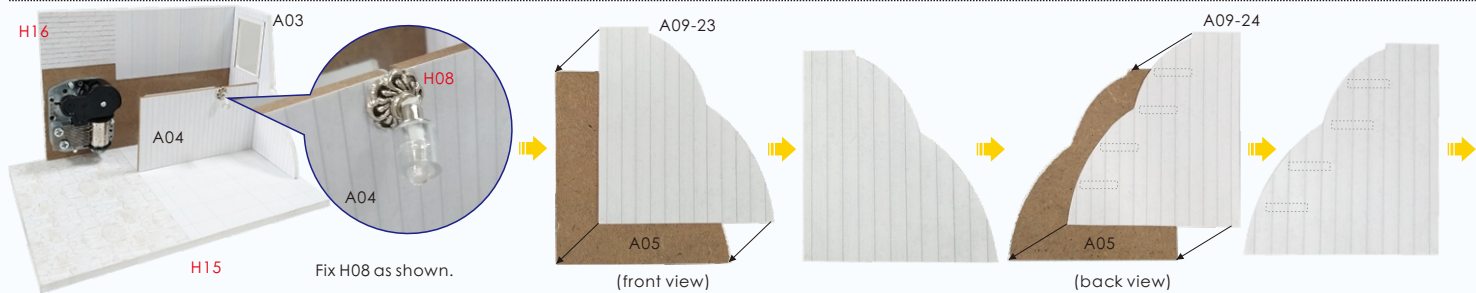
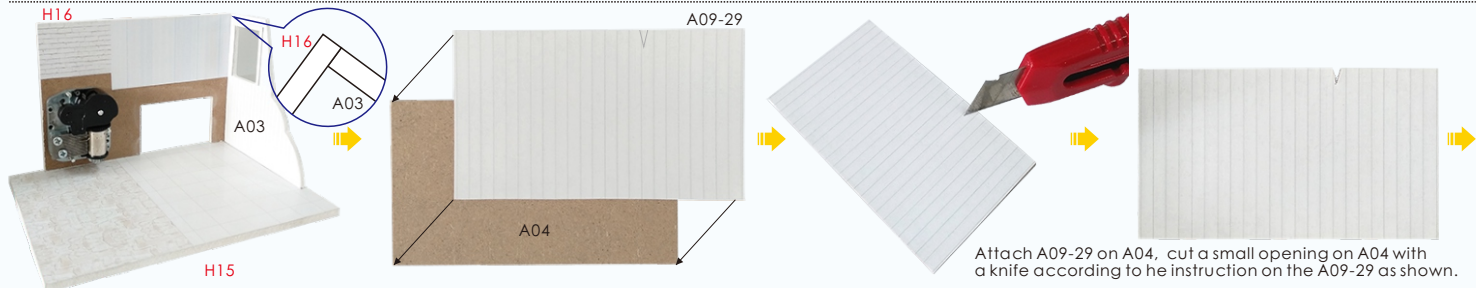

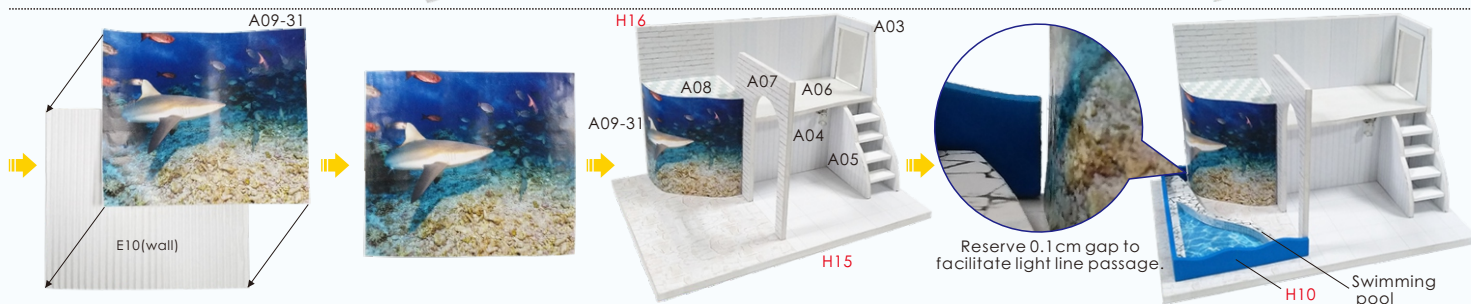
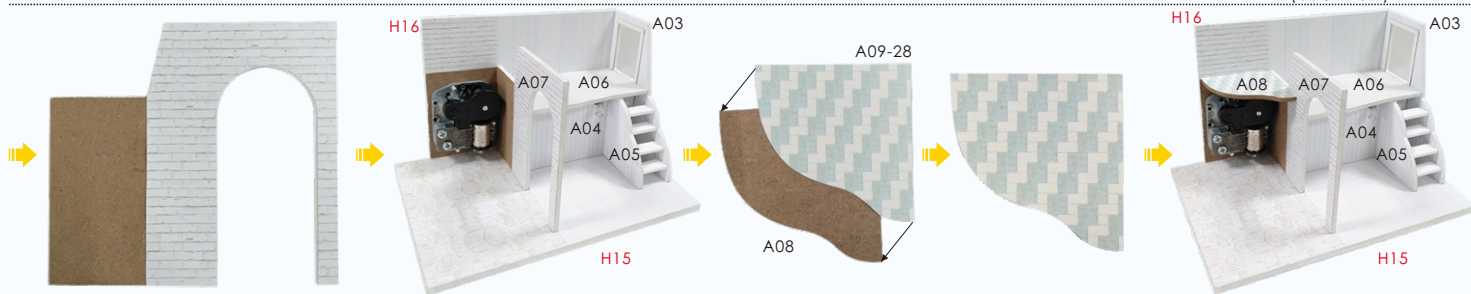
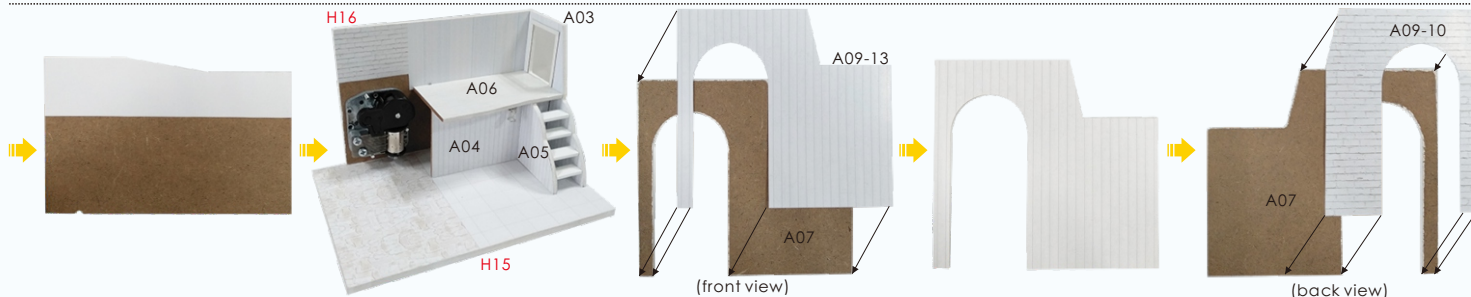



### How to assemble the battery holder

**Statement: the lamp wires cannot be inserted into the output socket.**

- - Can use 2 piece AAA size battery
- - Please notice the place of anode and cathode when put in the batteries
- - Rechargeable batteries are not blunt electricity
- - Rechargeable batteries can only be charged under adult supervision
- - Rechargeable batteries should be removed from the toy before charging
- - Different types of batteries cannot mix; Do not mix new batteries in use with semi-used batteries.
- - Run out of battery should be removed from the toy
- - The power shall not be short circuit

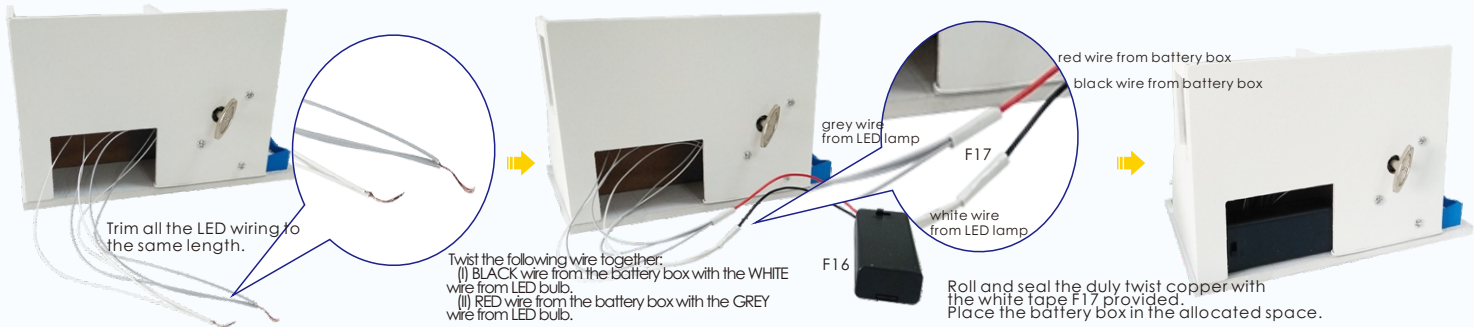

Installation of dust proof cover  
 (For updated version, the parts need to be purchased separately)



G04 Transparent cover  
 17\*10\*0.15cm 1piece



G05 Transparent cover  
 11.2\*10\*0.15cm 2pieces



G06 Transparent cover  
 10\*2.4\*0.15cm 1piece



G07 Transparent cover  
 17\*11.5\*0.15cm 1piece



1. Tear off kraft paper of each piece of transparent cover.

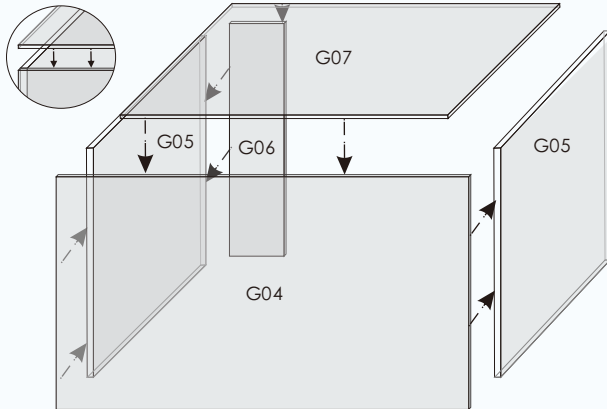

2. Paste G04, G05, G06 and G07 together to complete the dust proof cover as shown.

## Photo of Dust proof cover



## Photo gallery



**Attention: Please keep the instruction for future enquires after installation.**

